

Conductivity Sensor 4041

For high conductivities

4-electrode conductivity sensor with internal electrodes. Used with portable TCU series 3000.

Technical data

Materials	PVDF, EPDM and steel W 1.4404 (AISI 316L)
Pressure	max. 10 bar at 130 °C
Cell constant	1.0 ± 0.5 % (electrically adjusted) Calibrated in a > 80 mm beaker. When used with flow chamber type 74 gives an error of approx. +0.82 %
Reproduceability	±1.5 %
Linearity	From 200 000 to 50 µS/cm ± 1 % per decade
Temp. sensor	Pt 1000 (IEC 751 class A)
Time delay	T ₉₀ , 9 sec.
Protection	IP65 splash-proof (DIN 40 050)
Sensor cable	PVC 12 x 0.25 mm ² screened standard length 1 m max. temp. 70 °C
Connection	12-pole Binder
Weight	1.4 kg

74 flow chamber

Material	PVDF, EPDM and Duran® Borosilicate glass 3.3
Pressure	2 bar at 100 °C

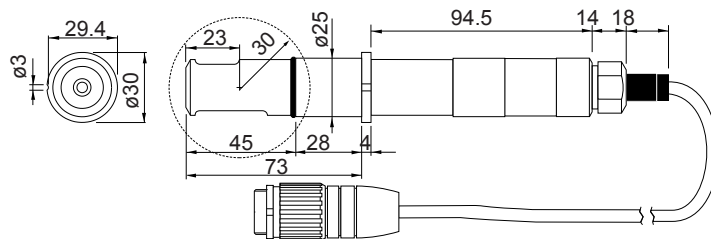
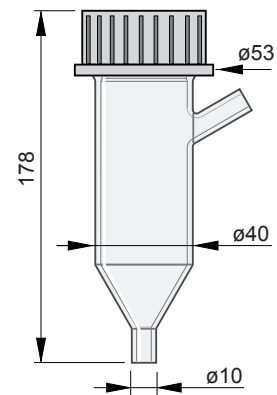
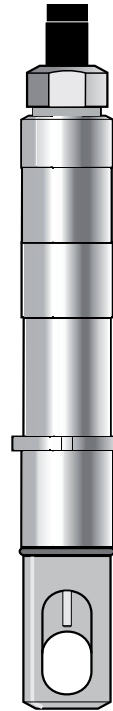

Dimensions in mm