

Slice lip replacement

A solution for better dry weight profiles

The slice lip is among the most delicate parts of a paper machine, and it has a significant effect on the cross-direction profiles.

Benefits

- Improves dry weight profile
- Reduces unplanned shutdowns
- Improves edge area stability

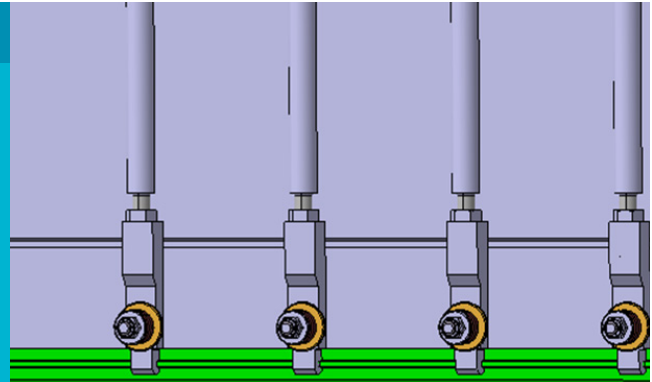

Service description

Optimal process profiles and end-product quality require that the headbox is in good mechanical condition. The slice lip suffers from wear and dents caused by headbox washings. Replacing the slice lip every one to three years helps maintain good profiles.

Scope of service

The service can include:

- Replacement of top slice lip
- Slice opening zeroing
- Slice opening profiling when required
- Loading springs replacement when required
- Top slice lip end seal replacement

| | |
|------------------------------|-----------------------|
| Recommended service interval | 4 years or need-based |
| Duration of full service | 8-16 hours |
| Performed during shutdown | 8-16 hours |
| Performed during operation | - |