

Custom Clips

Clips are the recommended method for tube shield attachment. Choose from Bull Style, Wrap Style or Overlap Style.

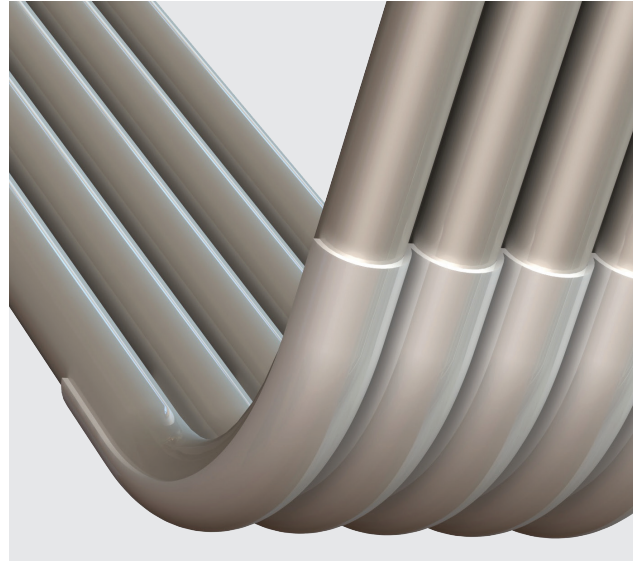

Custom Clips Specifications		
	Clip Style	Bull Overlap Wrap
	Tube Diameter	0.500" to 5.000" (Tube OD is shield ID) XML
	Angle of Wrap	Maximum 240° XML
	Gauge	7 to 24 XML
	Material	304 SS 316 SS 309 SS 310 SS 430 SS Inconel
	Clip Length	Standard is 1" XML
	Clip Extension (E)	Bull Style: 0" Standard Overlap Style: 0" Wrap Style: 1/2" Standard XML

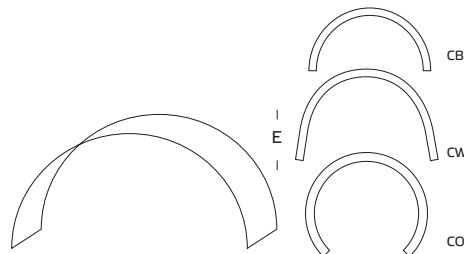

Process Information

Welding Certifications

ASME Code Stamps:
• S: ASME Section 1
• U: ASME Section VIII
• R: NBIC Repair of Pressure Vessels

Inspectors CWI certified

Stainless Steel Inventory

Valmet has an extensive inventory in sheet, bar, and welding materials maintained for heat resistant, corrosion resistant, and high temperature alloys. All products are purchased to proprietary customized specifications as well as normal industry standards with supporting documentation. The ability to obtain mill direct pricing and consignment inventory control has enabled our team to provide competitively priced products and control delivery of projects.

Location

Charlotte, NC