

# Custom Straight Shields

Straight Shields are available with angles of wrap between 90° to 240° and can be manufactured with straight ends, belled ends and flared legs. Complete coverage is available by overlapping shields.

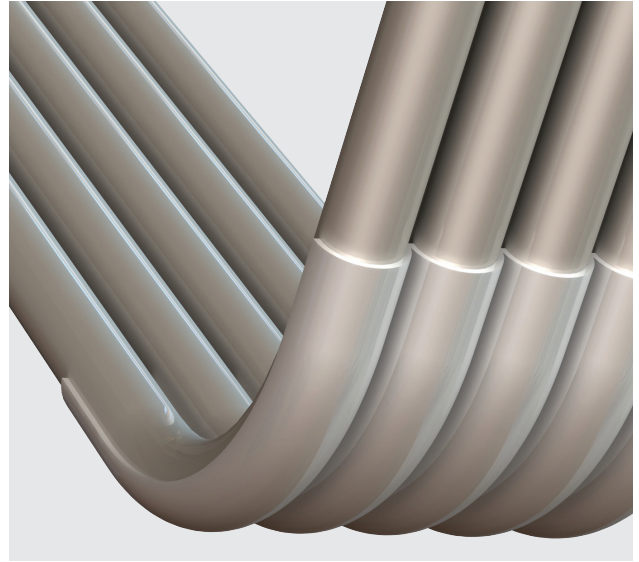

## Custom Straight Shield Options

	Tube Style	Belled end Flared legs Straight ends
	Tube Diameter	0.500" to 5.000" (Tube OD is shield ID) XML
	Angle of Wrap	90° to 240° XML
	Gauge	Recommend 10 to 24 XML
	Material	304 SS 316 SS 309 SS 310 SS 430 SS Inconel
	Length	Up to 120" XML

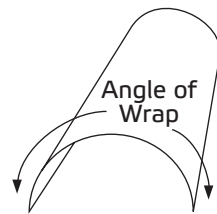

**S** Straight Shield With Straight Ends

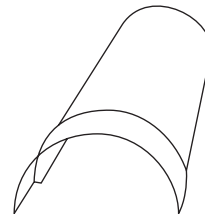

**B** Straight Shield With Belled End

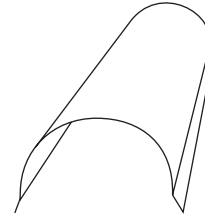

**F** Straight Shield With Flared Legs

## Process Information

### Welding Certifications

ASME Code Stamps:  
• S: ASME Section 1  
• U: ASME Section VIII  
• R: NBIC Repair of Pressure Vessels

Inspectors CWI certified

### Stainless Steel Inventory

Valmet has an extensive inventory in sheet, bar, and welding materials maintained for heat resistant, corrosion resistant, and high temperature alloys. All products are purchased to proprietary customized specifications as well as normal industry standards with supporting documentation. The ability to obtain mill direct pricing and consignment inventory control has enabled our team to provide competitively priced products and control delivery of projects.

### Location

Charlotte, NC