

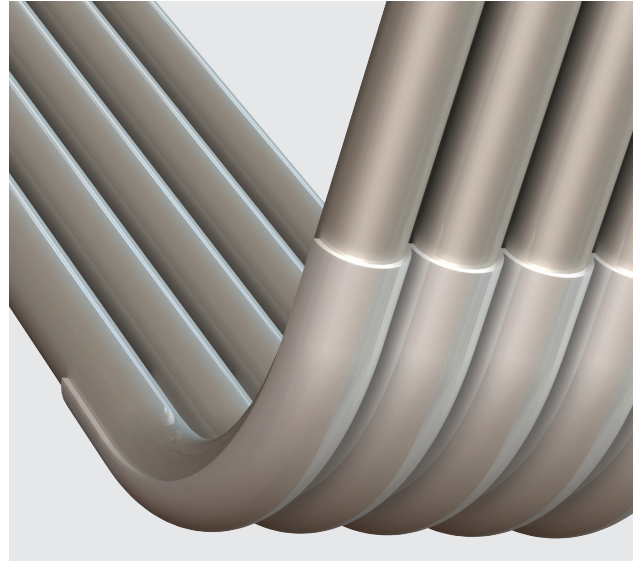

# 370° Tube Shields

For “new” shop applications, the 370° Tube Shield allows for complete coverage of tube surface without the need for overlapping two shields. Available in straight lengths only.



Custom 370° Tube Shield Options		
	Tube Diameter	0.500" to 5.000" (Tube OD is shield ID) XML
	Gauge	Recommend 10 to 24 XML
	Material	304 SS
		316 SS
		309 SS
310 SS		
430 SS		
Inconel		
Length	Up to 120"	
Process Information		
Location	Charlotte, NC	